



SONAIR-SXA15

Silenciadores de Escape para atenuações até 15 dB(A)

Material absorvedor sonoro interno em fibras minerais e chapa em aço perfurado. Envolvente exterior em chapa de aço carbono. Temperaturas de funcionamento até 650°C

Exhaust silencers (Mufflers) for noise reduction up to 15dB(A)

Sound absorber material in mineral fibers protected by perforated metallic steel sheets. Outer casing in carbon steel plate. Operating temperatures up to 650 °C

Silencieux d'échappement pour atténuations jusqu'à 15dB(A)

Matériel d'insonorisation en fibres minérales, protégées par des éléments métalliques perforées. Enveloppe extérieure en tôle d'acier au carbone. Températures de fonctionnement jusqu'à 650°C



Atenuação / Noise reduction / Atténuation [dB]

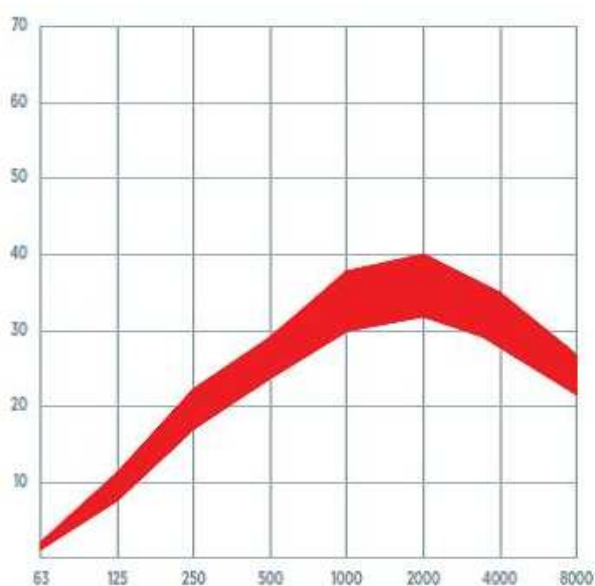

f [Hz] – Velocidades entre 30-80 m/s
Speeds between 30-80 m/s
Vitesses entre 30-80 m/s

Vel. m/s – Speed m/s – Vitesse m/s

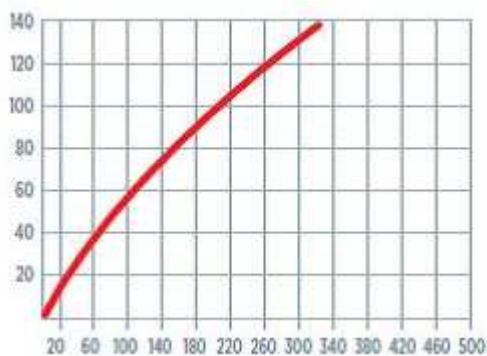

Perda de carga / Pressure drop / Chute de pression [mm.H₂O]





SONAIR SXA15

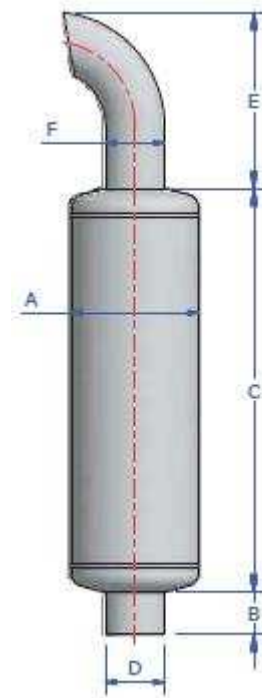
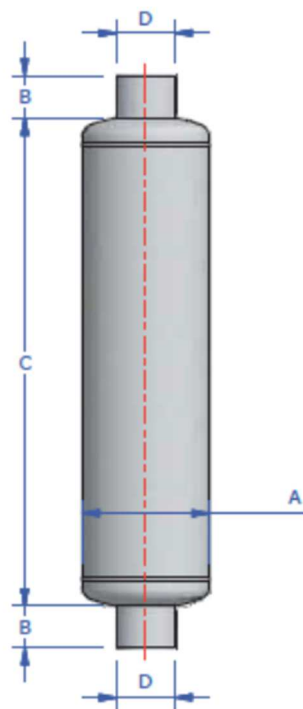

Mod.	Potência/Power/Puissance		Especificações/Specifications/Spécifications					curves	Peso/Weight/ Poids Kg
	KW	HP	A	B	C	D	E	F	
SXA15-07	0-10	0-14	76	80	250	40	120	35	1
SXA15-10c	10-23	14-31	100	80	300	45	150	40	3,5
SXA15-10c	23-37	31-50	100	80	450	50	170	40	3,5
SXA15-12	37-50	50-68	120	100	600	60	200	50	5
SXA15-15	50-75	68-102	150	100	700	70	250	60	8
SXA15-17	75-95	102-130	170	100	800	80	250	70	11
SXA15-20	95-120	130-163	200	100	900	89	*	*	14
SXA15-25	120-160	163-218	250	100	1000	114	*	*	21
SXA15-30	160-220	218-300	300	100	1100	139	*	*	29
SXA15-35	220-300	300-408	350	120	1150	168	*	*	36
SXA15-40	300-425	408-578	400	120	1300	193	*	*	52
SXA15-45	425-530	578-720	450	120	1500	219	*	*	66
SXA15-50	530-740	720-1006	500	150	1700	273	*	*	82
SXA15-55	740-1020	1006-1388	550	150	1900	324	*	*	145
SXA15-60	1020-1330	1388-1809	600	150	2100	356	*	*	180
SXA15-65	1330-1700	1809-2312	650	150	2300	406	*	*	200

* A Pedido do cliente / Custom designed / Conçu sur mesure

